

FANTINI MILANO FLOOR MOUNTED MIXER

[328103]

NOTE

- At rough in stage install base plate and connect hot and cold supplies. 1/2 BSP connections.
- Secure base plate to sub-floor, with dynabolts or other suitable fixings.
- Full instructions supplied with the product.
- Maximum working pressure 1000kpa. Minimum working pressure 100kpa. Recommended working pressure 200 - 500kpa.
- Brazed connections should NOT be made directly onto the mixer plate as excessive heat will damage the plate.
- Supply pipe work must be flushed clean before installation.
- Full installation instructions come with the product.

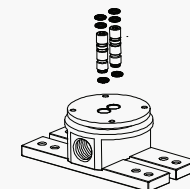
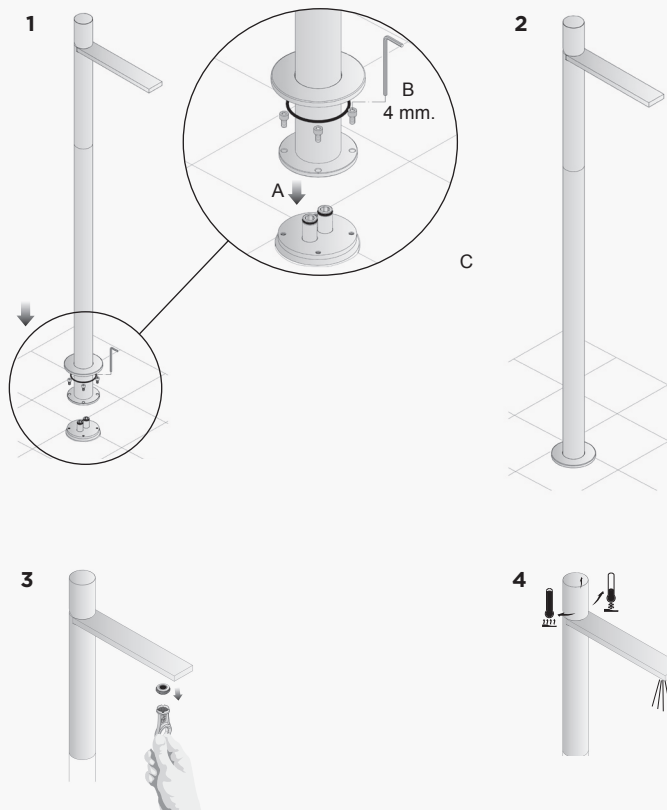

MIXER FLOOR PLATE

- Hot and cold connections 1/2 BSP
- This plate must be installed sub floor at rough in stage.